



19 ABBOTS RISE, REDHILL, SURREY, RH1 1LL
£375,000
FREEHOLD

***** REFURBISHMENT REQUIRED *****

***** THREE BEDROOM TERRACED HOUSE IN A QUIET CUL DE SAC CLOSE TO REDHILL STATION *****

Abbots Rise is a private development comprising a small number of houses and apartments, situated only a short walk from Redhill town centre and train station.

The house itself is an excellent opportunity for somebody wishing to make their own mark on a property.

Through the front door there is an entrance hall with stairs to the first floor. You have a good size living room with a separate dining room that has storage built in, an arch through to a kitchen and sliding doors to a double glazed conservatory. On the first floor there is a landing with an airing cupboard and loft access, a good size main bedroom with fitted wardrobes, two further bedrooms and a family bathroom.

Outside you have two allocated parking spaces, one in front of the house, the other directly opposite. At the rear there is a 35ft garden, that has a patio area, some lawn and fenced boundaries.

Redhill Station can be found just under half a mile away, and offers direct trains to central London in as little as 29 minutes, with services to Gatwick, Tonbridge, Guildford and Reading.

The town centre of Redhill has seen much redevelopment in recent years, and now benefits from a multiscreen cinema complex, a Sainsburys superstore, 24 hour gym and a weekly local market in the square. In addition, there are a number of pubs and restaurants, as well as a shopping centre and a leisure centre.

- | | |
|--------------------------|--------------------------|
| ■ TERRACED HOUSE | ■ REFURBISHMENT REQUIRED |
| ■ LOUNGE AND DINING ROOM | ■ CONSERVATORY |
| ■ KITCHEN | ■ THREE BEDROOMS |
| ■ TWO PARKING SPACES | ■ QUIET LOCATION |
| ■ COUNCIL TAX BAND: E | ■ EPC RATING: C |





ROOM DIMENSIONS:

ENTRANCE HALL

5'6 x 3'11 (1.68m x 1.19m)

LOUNGE

14'5 x 11'6 (4.39m x 3.51m)

DINING ROOM

10'2 x 7'10 (3.10m x 2.39m)

KITCHEN

10'6 x 6'8 (3.20m x 2.03m)

CONSERVATORY

13'3 x 6'4 (4.04m x 1.93m)

FIRST FLOOR

LANDING

BEDROOM ONE

12'6 x 8'6 (3.81m x 2.59m)

BEDROOM TWO

9'5 x 7'4 (2.87m x 2.24m)

BEDROOM THREE

7'8 x 7'3 (2.34m x 2.21m)

BATHROOM

6'5 x 6'1 (1.96m x 1.85m)

GAS CENTRAL HEATING

DOUBLE GLAZED WINDOWS

35FT REAR GARDEN

TWO PARKING SPACES

ESTATE CHARGE: £329 PER ANNUM



GROUND FLOOR
440 sq.ft. (40.8 sq.m.) approx.

1ST FLOOR
356 sq.ft. (33.1 sq.m.) approx.

TOTAL FLOOR AREA: 795 sq ft (73.9 sq m) approx.

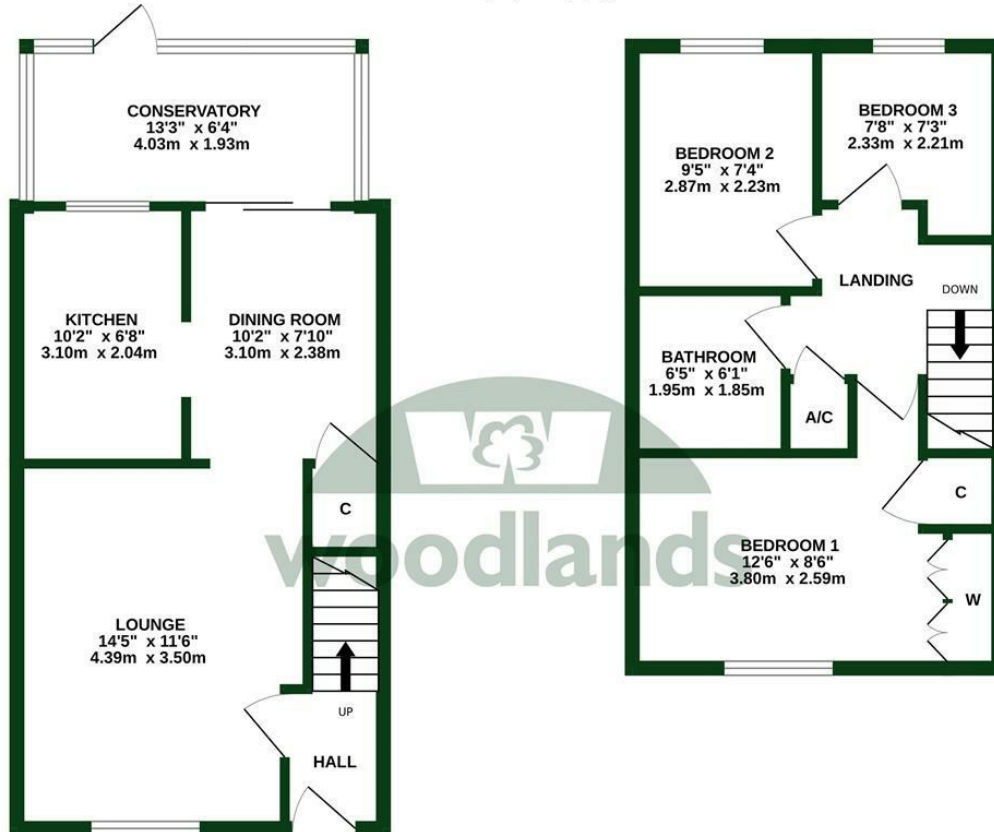

Whilst every attempt has been made to ensure the accuracy of the floorplan contained here, measurements of doors, windows, rooms and any other items are approximate and no responsibility is taken for any error, omission or mis-statement. This plan is for illustrative purposes only and should be used as such by any prospective purchaser. The services, systems and appliances shown have not been tested and no guarantee as to their operability or efficiency can be given.
Made with Metropix ©2025



woodlands



Energy Efficiency Rating		
	Current	Potential
Very energy efficient - lower running costs		
(92 plus) A		
(81-91) B		
(69-80) C	76	80
(55-68) D		
(39-54) E		
(21-38) F		
(1-20) G		
Not energy efficient - higher running costs		
England & Wales	EU Directive 2002/91/EC	

To view this property please call 01737 771777

www.woodlands-estates.co.uk

These particulars are set out as a general outline for the guidance of intending purchasers or lessees and do not constitute any part of an offer or contract. No person in the employment of the above named agents has any authority to make or give any representation or warranty whatsoever in relation to this property. If there is any point which is of particular interest, please contact our office and we will be pleased to check the information. The mention of any appliances and/or services does not imply they are in full and efficient working order.